

AUBO i3

Technical Specifications & Data Sheet

6 Axis
3kg Payload
625mm Reach

Your AUBO Distributor



icrservices.com
(586) 582-1500



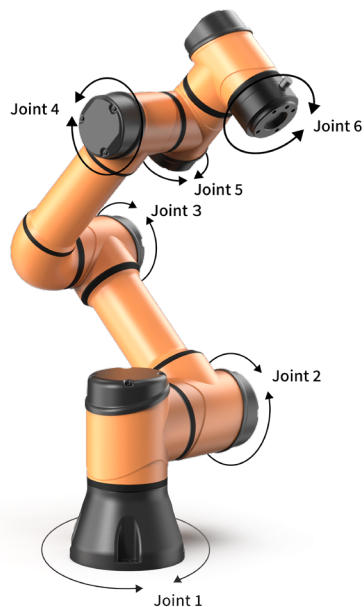

The AUBO i3 is a compact and lightweight collaborative robot designed to propel your organization towards progress. Built with a focus on efficiency, the AUBO i3 shines in tight clearances and small workspaces, whether on a benchtop or inside machinery. Despite its small size, it boasts full degree rotation on all wrist joints, enabling precise and repeated movements for light assembly tasks.

SPECIFICATIONS

Payload	3 kg
Reach	625 mm
Weight	16 kg
Mounting Base Footprint	Ø140 mm
Avg. Power Consumption	150 W
Peak Power Consumption	1000 W
Operating Temperature	0-50 °C
Humidity	90% Relative Humidity (No Condensation)

CONTROL BOX SPECIFICATIONS

Size (L x W x H)	390mm x 370mm x 265mm
Weight	15 kg
Robot Cable Length (Customizable)	5 m
Teach Pendant Cable Length	4 m
Power Supply Cable Length	5 m
Communication Protocols	Ethernet TCP/IP, ModBus-RTU/TCP, Profinet
I/O Ports	
Digital Input	16 (User) / 16 (Safety)
Digital Output	16 (User) / 16 (Safety)
Analog Input	4
Analog Output	4
I/O Power Supply	24V 3A
Power Supply Requirements	100-240VAC, 50-60Hz
Open Source Development Support	SDKs in C/C++/C#/Lua/Python, ROS, Plug-in Support

MOVEMENT

Repeatability (ISO 9283)	±0.02 mm
Tool Velocity	≤1.9 m/s

Axis Movement	Working Range	Maximum Speed
J1 Base	±360°	178°/s
J2 Shoulder	±360°	178°/s
J3 Elbow	±360°	178°/s
J4 Wrist	±360°	237°/s
J5 Wrist	±360°	237°/s
J6 Wrist	±360°	237°/s

FEATURES

Mounting Orientation	Any Orientation
IP Classification	IP 54
ISO 1644-1 Clean Room Level	Class 5

Tool I/O Ports	
Digital Input	4 (Customizable)
Digital Output	4 (Customizable)
Analog Input	2
Analog Output	-

I/O Power Supply	
Output Voltage	0V/12V/24V
Output Current	0.8A

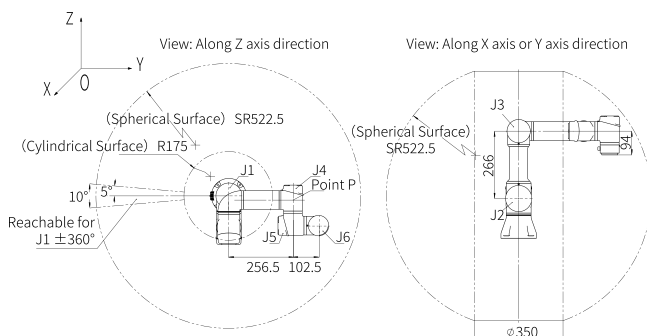

WORKSPACE DIMENSIONS

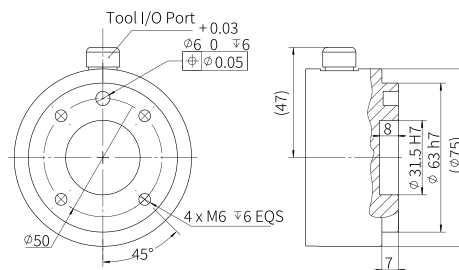

END FLANGE DIMENSIONS

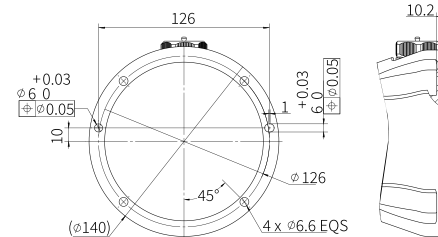

ROBOT BASE TOP VIEW

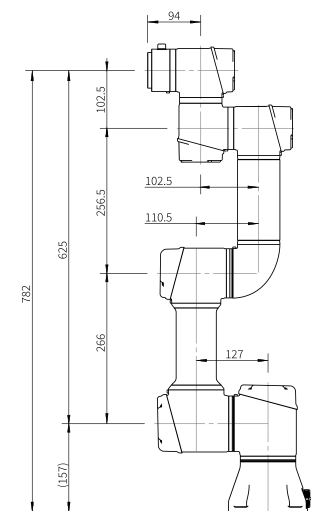

PRODUCT DIMENSIONS